

SPILLWAY & BOX CULVERT PLAN VIEW
(SCALE: 1"=10')

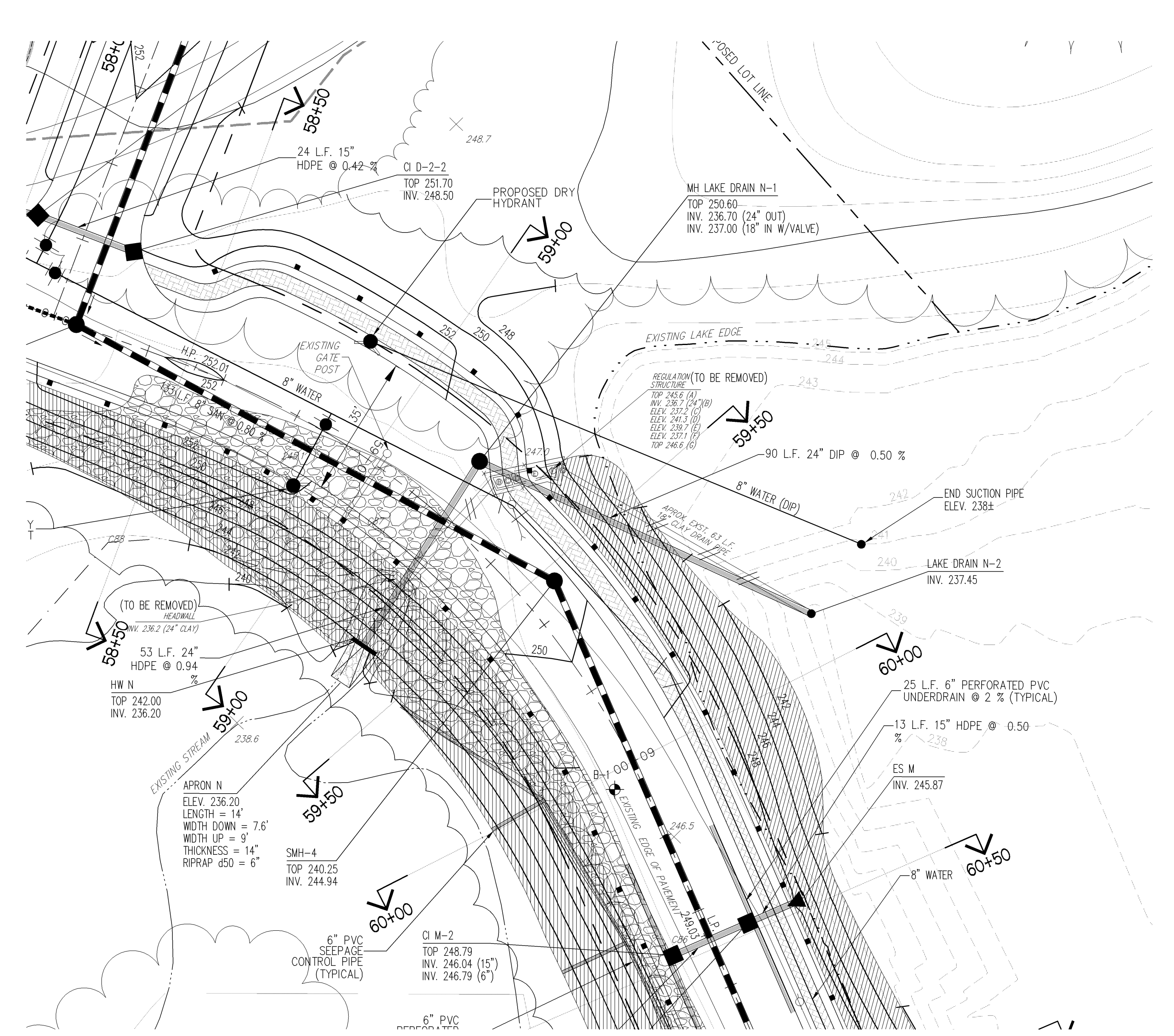

LAKE DRAIN PLAN VIEW
(SCALE: 1"=20')

LEGEND	
	EXISTING CONTOUR
	EXISTING UNDERWATER LAKE CONTOUR
	EXISTING SPOT GRADE
	EXISTING UTILITY POLE
	EXISTING EASEMENT
	EXISTING LAKE EDGE
	EXISTING WETLANDS BOUNDARY
	EXISTING STREAM LINE
	EXISTING WETLAND BUFFER BOUNDARY
	EXISTING VEGETATION BOUNDARY
	EXISTING STORM SEWER PIPE
	PROPOSED CURB
	PROPOSED R.O.W. LINE
	PROPOSED LOT LINE
	PROPOSED SPOT GRADE
	PROPOSED MANHOLE
	PROPOSED DRAIN INLET
	PROPOSED END SECTION
	PROPOSED HEAD WALL
	PROPOSED WOOD GUIDE RAIL
	PROPOSED STORM SEWER PIPE
	PROPOSED VEGETATION BOUNDARY
	PROPOSED 8" SANITARY SEWER MAIN
	PROPOSED SANITARY FORCE MAIN
	PROPOSED WATER MAIN
	PROPOSED CONCRETE SIDEWALK
	PROPOSED GATE VALVE
	PROPOSED DRY HYDRANT
	PROPOSED RIP RAP SLOPE
	SEEPAGE CONTROL AREA
	BORING LOCATION

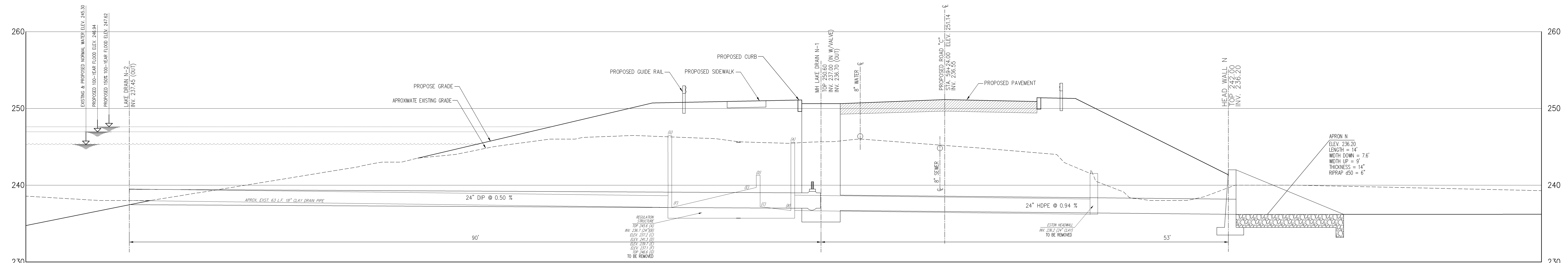

LAKE DRAIN PIPE "N" PROFILE
(SCALE: 1"=5H 1"=5V)

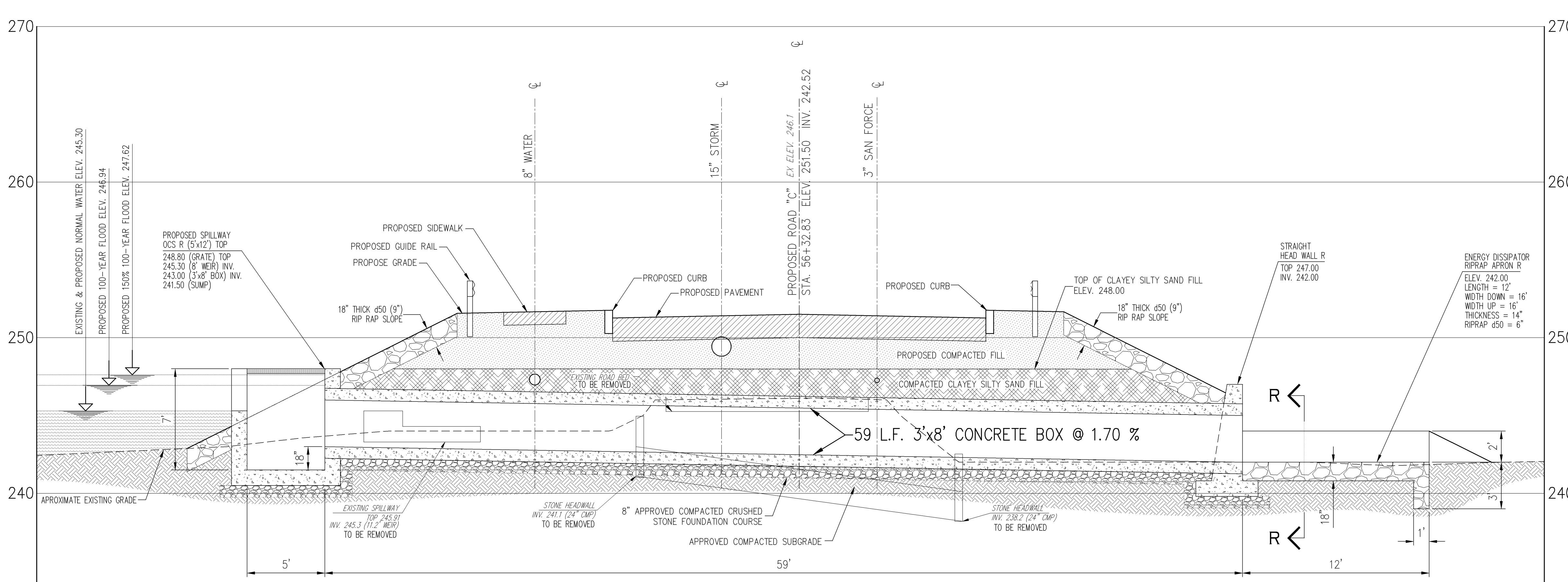

CROSS SECTION STA. 58+32.83
(SCALE: 1"=4H 1"=4V)

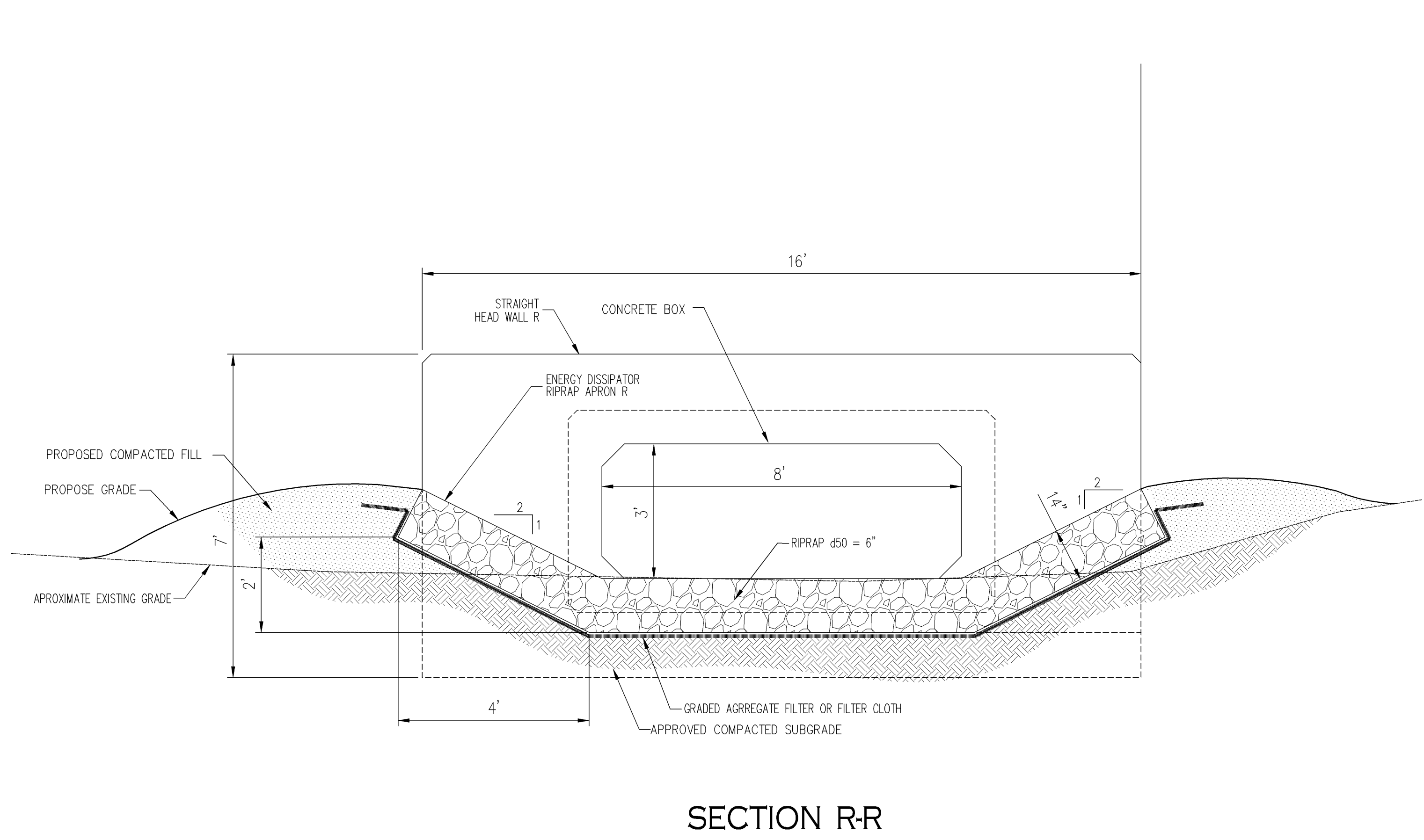

SECTION RR
(SCALE: 1"=2H 1"=2V)

NOT FOR CONSTRUCTION
COPYRIGHT © 2006 By John Meyer Consulting
All Rights Reserved. No part of this document may be reproduced, stored in a retrieval system, or transmitted in any form or by any means, electronic, mechanical, photocopying, recording, or otherwise, without the prior written permission of John Meyer Consulting, Inc. This document is the property of John Meyer Consulting, Inc. and is loaned to you for your use only. It is not to be distributed to other parties without the prior written permission of John Meyer Consulting, Inc. and may be subject to change without notice.

REV	DATE	BY	CHKD	REVISION
1	12/13/2006	JM	JM	ISSUED FOR PERMITS AND TOWN COMMENTS
2	07/10/2007	JM	JM	REVISED AS PER INSPECTOR AND TOWN COMMENTS
3				SUBMIT TO INSPECTOR

LAKE WALTON PARK, LLC
150 NORTH WACKER DRIVE - SUITE 1120
CHICAGO, IL 60606

JMC
JOHN MEYER CONSULTING
120 Bedford Road
Armonk, NY 10504
voice 914.273.5225 • fax 914.273.2102
mail@johnmeyerconsulting.com

SPILLWAY IMPROVEMENT PLAN
LAKE WALTON PARK
LAKE WALTON ROAD
TOWN OF EAST FISHKILL, NY

DESIGN	PS	APPROVED	JM
SCALE	1"=20'		
DATE	08/08/2005		
PROJ. NO.	3006		
SHEET NO.	DM-CULV-8	5	14

DD-2